



Customized Elevator Solutions

**MRL MR MOD**





# ADVANCED TECHNOLOGY

We are constantly working on further developments of our systems as well as on new developments of components to be able to provide state-of-the-art technology and tailor-made solutions to our customers.



**SMW Elevator AB** - is a dynamic, fast-growing and innovative elevator company with worldwide business connections. The consequent and quick implementation of individual customer wishes makes us successful.

Our business address is in Sweden in Skogas/Stockholm. At this location administration, sales, development and project management are operating. Engineers with many years of experience in the elevator industry are working in our team.

Our own development competence makes us independent of usual market solutions. Our own innovative technology combined with lean organizational structures as well as flexibility enables us to offer high quality and customized solutions to an excellent price performance ratio.

Our goal is to convey a sense of added value to our customers, which is connected to each of our products and services. The passion and the attention to detail as well as the use of leading technologies for our products and processes help us to achieve this goal.

Regardless of price, we maintain a high standard of quality through the entire product range.

A dynamic growing environment demands for continuous improvements and adaptations of products and processes of each company. In order to achieve this sustainably in the future and to keep our quality standards, we improve continuously our processes and our products..







## CONTENT

Overview	8-9
Advantages	11
Doors	12-13
Operating and indicating panels	14-17
Cabins	19-25
Controlling system	27-31
Layout	32-38



## OVERVIEW

**B-CORE MRL**  
WITHOUT MACHINE ROOM

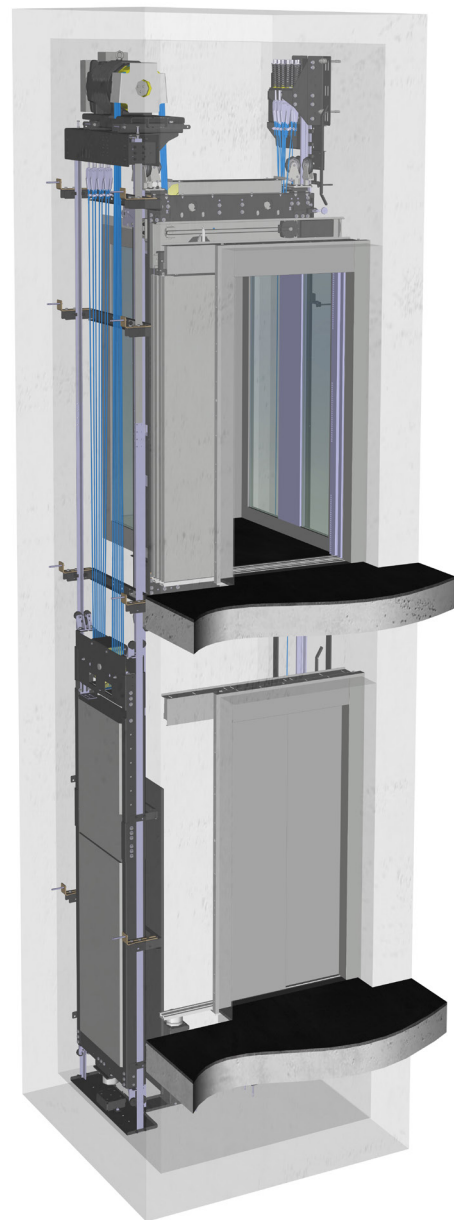

**B-CORE MR**  
WITH MACHINE ROOM



«**B-CORE**» – is a machine-room-less electric elevator with high ride quality and low noise emission. The system is available in a machineroomless execution or with a small machine room. B-CORE is developed and produced self-directed. Being designed for a wide variety of buildings, the modular construction kit provides customized solutions for almost every use case – in single and group control.

The core components were developed and qualified considering strict quality standards according to the latest state of engineering art. Innovation, reliability and efficiency represent the leading principles here.

With the ambition to reach the perfect harmonic interaction of control system, mechanical structure and the drive train, this flexible elevator system has arisen.

Modern technology in combination with approved techniques ensure a quick installation, as well as an uncomplicated and anticipatory maintenance.

Numerous options are available to meet the individual needs of the intended purpose.

### **B-CORE MRL**

is a machineroomless electric rope lift. For this type of elevator, no additional machine room is needed. The gearless drive and the control unit are located in the shaft head. The control unit is usually located in the top landing next to the shaft door, in front of the door frame or integrated inside the door frame.

This space-saving design avoids disruptive roof structures and gains valuable usable space.

### **B-CORE MR**

is an electric rope lift with a small machine room above the shaft. The gearless drive including the control and regulation unit is located in the machine room.

### **B-CORE MOD**

is a highly flexible electric rope lift. The elevator system has been specially designed for the modernization of existing elevators. The highly compact design increases the value of your building, realizing larger cabin areas with state-of-art technology. Therefor we offer different modernization packages, from complete replacement to the replacement of single assemblies.





## ADVANTAGES

### Brief overview of ADVANTAGES

- Realization of a shaft pit of minimum 400mm independent to cabin dimensions.
- With the application of an underslung cabin, regardless of the cabin dimensions, shaft heads of minimum 2500mm and shaft pits of minimum 450mm can be realized.
- Cabin widths and cabin depths can be realized in 1 mm increments
- Minimal transfer of lateral forces into the side walls of the shaft - advantages in statics and noise transmission
- Centrally guided overslung ride unit - excellent ride comfort
- Unlimited possibilities of cabin design
- Unlimited possibilities of door executions
- Same technology up to rated speeds of 2.5 m/s
- Easy installation and commissioning
  - pre-assembled and pre-configured components
  - Plug and Play
- Integrated access control in the cabin as standard function
- Online / GSM service to support commissioning
- Integrated monitoring system as standard function
- Preventive maintenance through E-Service
- Integrated emergency call system via GSM
- Analog load measuring device as standard function ensures a smooth driving comfort
- Protection classes of IP54 and higher are possible



We deliver automatic doors in standard:

- **2PS:** Two panel side opening
- **2PC:** Two panel center opening
- **4PC:** Four panel center opening



T-100

T-200

T-300

- T-100:** Door panels out of powder coated steel or stainless steel brushed
- T-200:** Glass door panels out of laminated safety glass with full frame out of powder coated steel or stainless steel brushed
- T-300:** Glass door panels out of laminated safety glass with frame on top and bottom out of powder coated steel or stainless steel brushed

The door frame is made out of powder coated steel or stainless steel brushed at all executions.

STANDARD SURFACE FINISHING

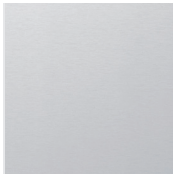

Stainless steel brushed



Powder coating RAL7032

Following fire resistances of the shaft doors type ST-100 are available acc. to EN81-58: E120, EW60, EI30, EI60

Further options are available on demand.

CABIN DOOR



- modern frequency regulated synchronous drive
- noise level <50 dB
- adjustable opening and closing speed
- power consumption in standby mode 4W
- up to 360 cycles per hour
- non-contact monitoring by a high-resolution light curtain
- EN81-20/50 conform

DOOR SILLS

- Aluminum sills are supplied in standard
- Stainless steel sills can be supplied optionally

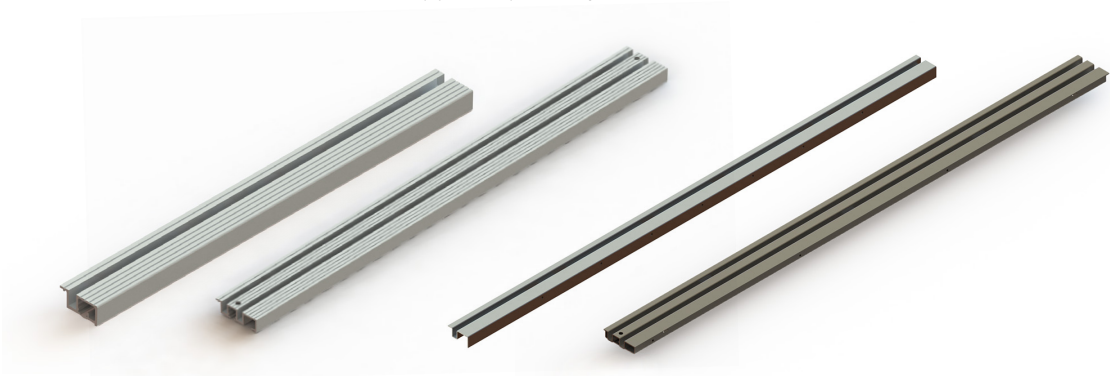

Aluminium

Stainless steel



BUTTONS



**MT42**  
Dimension 34x34mm  
Push plate 28x28mm  
Matt stainless steel



**RT42**  
Dimension Ø 34mm  
Push plate Ø 28mm  
Matt stainless steel

LANDING OPERATING PANELS



**LOP-S1**  
**LOP-S2**  
**LOP-F1**  
**LOP-F2**



**LOP-S1-LCD**  
**LOP-S2-LCD**  
**LOP-F1-LCD**  
**LOP-F2-LCD**



**LOP-S1-LCD+**  
**LOP-S2-LCD+**  
**LOP-F1-LCD+**  
**LOP-F2-LCD+**

The body is made of matt stainless steel. The elements can be attached to the wall next to the shaft door or to the shaft door frame (observing the rules for required fire protection class).

Shortcut	Explanation
LOP	Landing operating panel
S1, S2	S = Surface mounted, 1 = 1 button, 2 = 2 buttons
F1, F2	F = Flat mounted, 1 = 1 button, 2 = 2 buttons
LCD	Direction indicator
LCD+	Direction and position indicator

LANDING INDICATING PANELS



**LIP-S-TFT3**  
**LIP-S-TFT5**  
**LIP-F-TFT3**  
**LIP-F-TFT5**

**LIP-S-R**  
**LIP-F-R**

Optionally, full color TFT displays can also be used in the landings. The elements can be mounted on the wall above or next to the landing door.

Shortcut	Explanation
LIP	Landing indicating panel
S	Surface mounted
F	Flat mounted
TFT3	TFT-indicator, 3 = 3 inch
TFT5	TFT-indicator, 5 = 5 inch
R	Illuminated directional arrows



CABIN OPERATING PANEL S SERIES



COP-S-TFT5  
COP-S-TFT9

Our newly developed exclusive cabin operating panel of the **S series** is equipped with a full color TFT display and allows a flexible positioning inside the cabin by surface mounting.

It provides the highest visual overview to the passengers. The height is 1270mm.

The **standard version** includes:

- buttons braille and tactile
- integrated access control via Dallas Key - Reader
- door-close and door-open-button
- intercom
- call cancelation function in the cabin
- type plate
- 5" TFT display
- brushed stainless steel body
- emergency button

The **available options** are:

- VIP key switch
- body made of other materials (e.g. stainless steel linen or powder-coated steel)
- body with LED - Backlight
- preparation for code card reader
- 9" TFT display
- text announcement

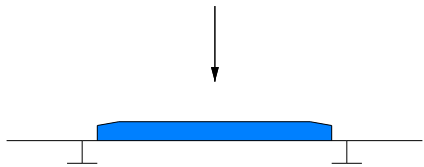

CABIN OPERATING PANEL F SERIES



COP-F-TFT5  
COP-F-TFT9

Our elegant fully integrated cabin control panel of the **F series** is equipped with a full color TFT display and fits through the integrated mounting optimally in the cabin wall.

The panels of the F series are individually adapted to the cabin height.

The **standard version** includes:

- buttons braille and tactile
- integrated access control via Dallas Key - Reader
- door-close and door-open-button
- intercom
- call cancelation function in the cabin
- type plate
- 5" TFT display
- brushed stainless steel body
- emergency button
- Slightly raised with bevelled edges

The **available options** are:

- VIP key switch
- body made of other materials (e.g. stainless steel linen or powder-coated steel)
- preparation for code card reader
- 9" TFT display
- text announcement
- fully flush mounting

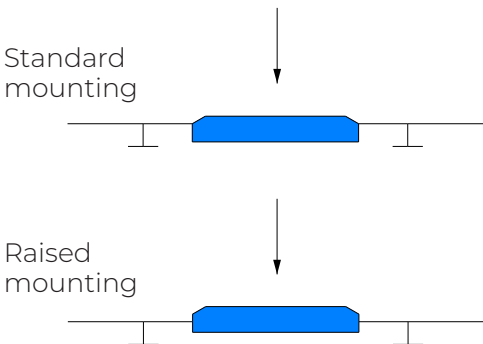





CABINS

ELEGANCE  
STAINLESS STEEL

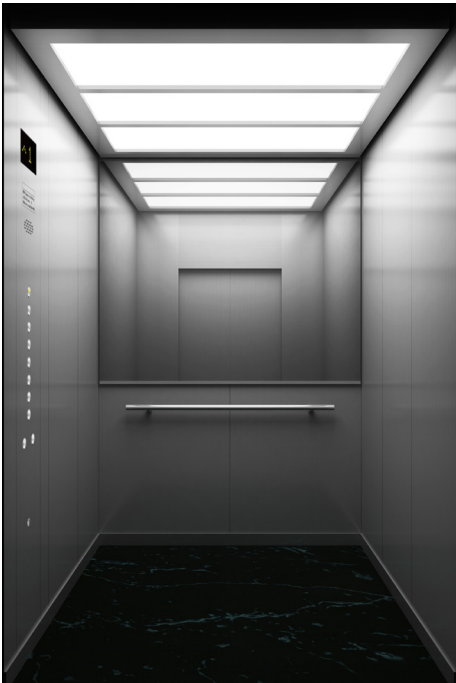

CLASSIC  
POWDER COATING

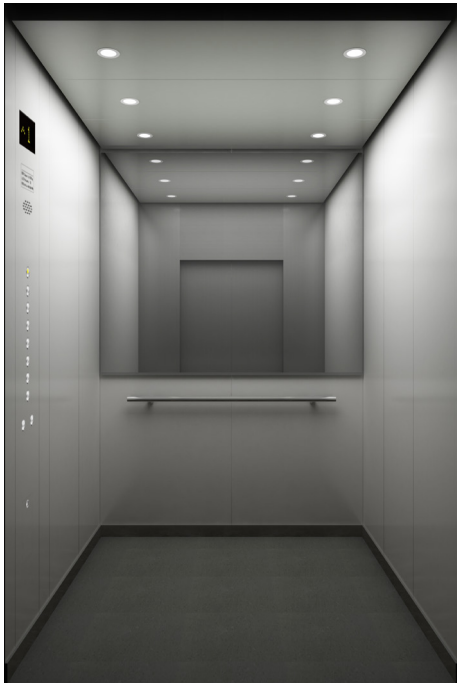

AMBIENTE  
GLASS



PANORAMA  
SPECIAL CABINS





ELEGANCE  
STAINLESS STEEL

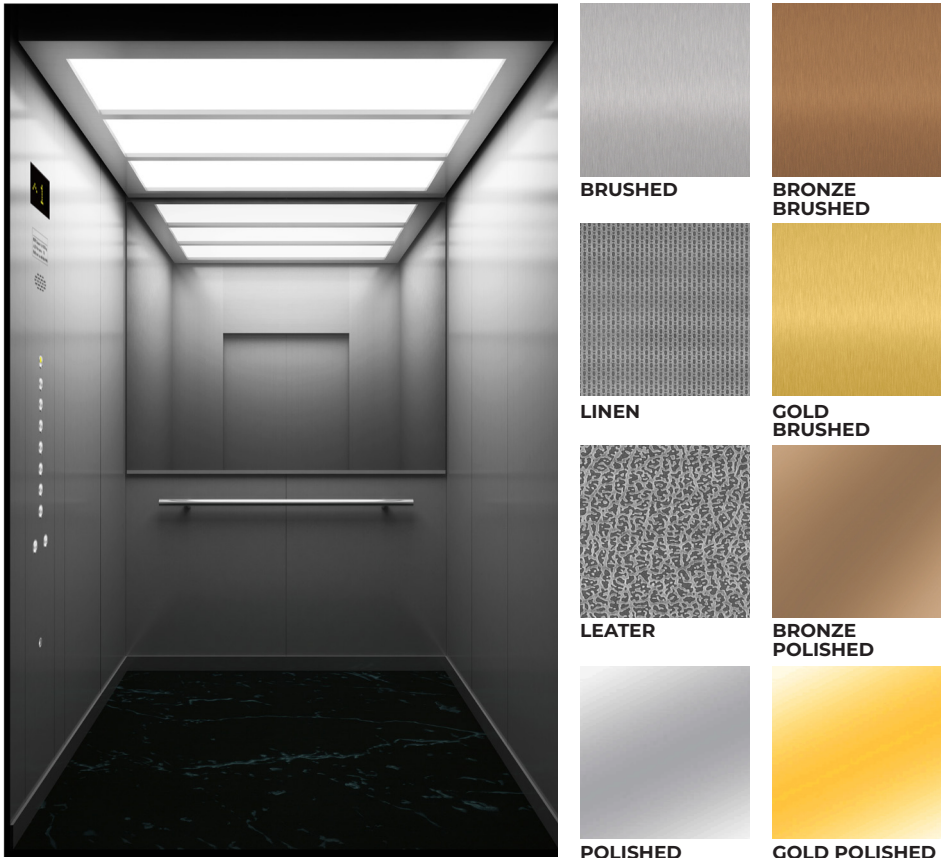

Standard scope of supply

- Walls:** Stiff car panel construction in brushed stainless steel.  
Other stainless steel designs are available according to our «Stainless Steel Design Collection».
- Ceiling:** Traversable, suspended ceiling made of brushed stainless steel with matt-white acrylic glass and fluorescent tubes or optionally with LED lighting. Other versions are available acc. to «accessories ceilings».
- Flooring:** Linoleum. Further variants are available acc. to «Accessories floor coverings».
- Skirting:** brushed stainless steel.
- Car entrance panels:** brushed stainless steel.
- Mirror:** safety glass with polishes edges, ½ height on back wall.
- Car operating panel:** integrated column panel of the **F Series** or surface mounted panel of the **S Series**.

CLASSIC  
POWDER COATED

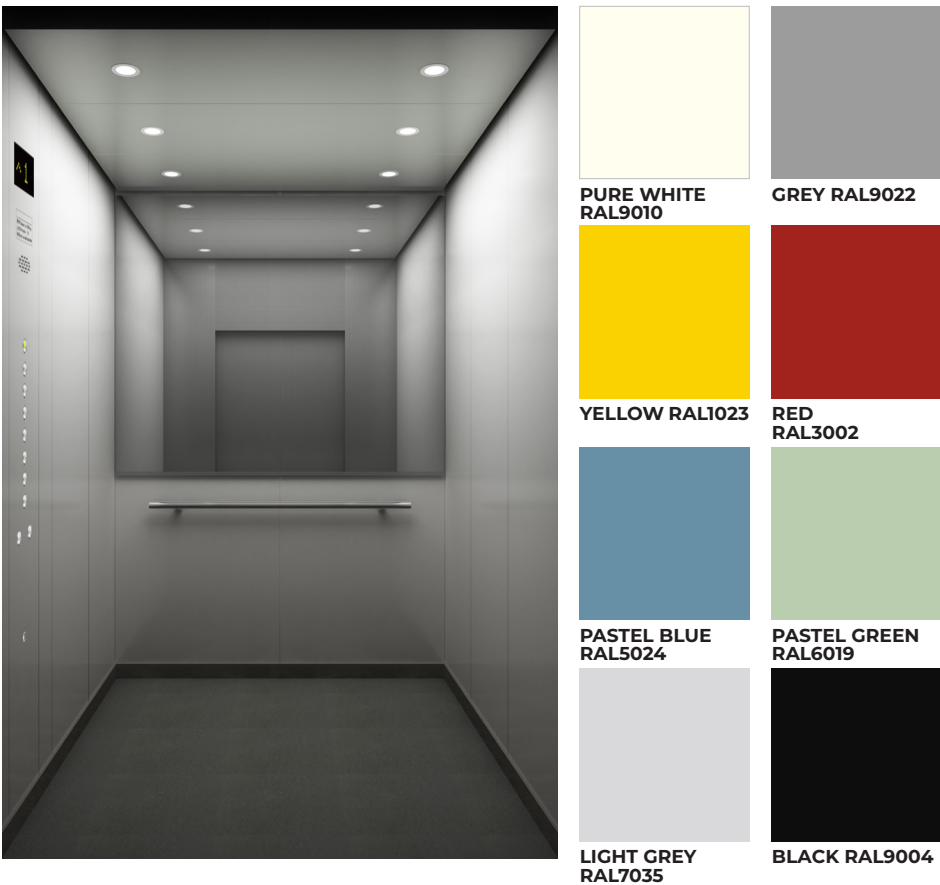

Standard scope of supply

- Walls:** Stiff car panel construction out of powder coated steel according to our «RAL Colors Collection».
- Ceiling:** Traversable, suspended ceiling made of powder coated steel (RAL 9010) with matt-white acrylic glass and fluorescent tubes or optionally with LED lighting. Other versions are available acc. to «accessories ceilings».
- Flooring:** Linoleum. Further variants are available acc. to «Accessories floor coverings».
- Skirting:** powder coated steel.
- Car entrance panels:** powder coated steel.
- Mirror:** safety glass with polishes edges, ½ height on back wall.
- Car operating panel:** integrated column panel of the **F Series** or surface mounted panel of the **S Series**.



AMBIENTE  
GLASS



	
PURE WHITE RAL9010	RED RAL1586
	
IVORY RAL1014	LIGHT BROWN RAL1236
	
WHITE ALUMINIUM RAL9006	RED ORANGE RAL2001
	
METAL BLU RAL1435	LUM GREEN RAL1164

Standard scope of supply

- Walls:** Stiff car panel construction out of zinc-coated steel clad with glass panels acc. to our «Glass Panel Collection».
- Ceiling:** Traversable, suspended ceiling made of brushed stainless steel with matt-white acrylic glass and fluorescent tubes or optionally with LED lighting. Other versions are available acc. to «accessories ceilings».
- Flooring:** Linoleum. Further variants are available acc. to «Accessories floor coverings».
- Skirting:** brushed stainless steel.
- Car entrance panels:** brushed stainless steel.
- Mirror:** safety glass with polished edges, ½ height on back wall.
- Car operating panel:** integrated column panel of the **F Series** or surface mounted panel of the **S Series**.

PANORAMA  
SPECIAL CABINS

- Individual design
- Various geometric shapes
- Unlimited design possibilities
- Framed and frameless execution
- Exclusive materials





ACCESSORIES  
FLOORING

LINOLEUM

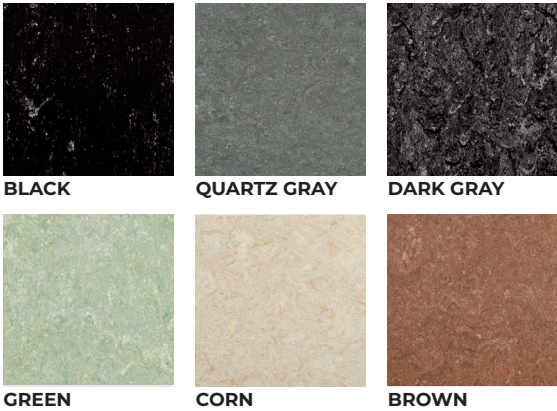

MARBLE

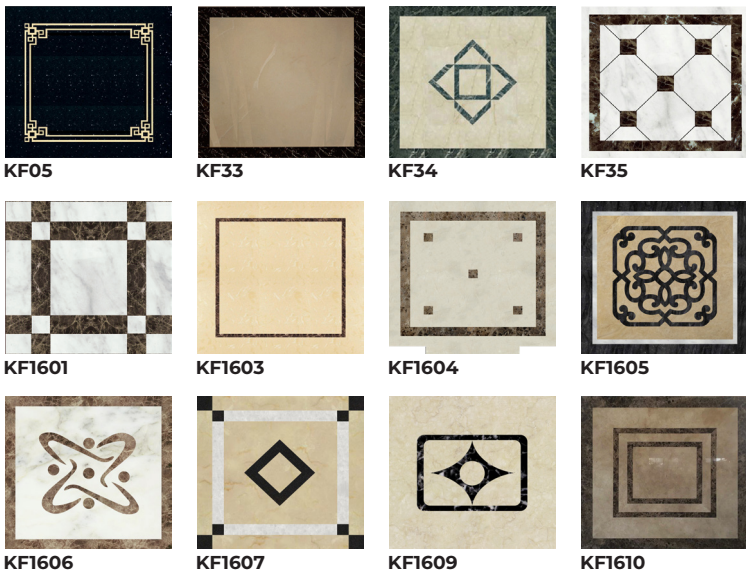

Lowering for  
on-site flooring

For an on-site floor covering (e.g. tiles)  
a floor lowering X of 10 - 40mm can be  
provided.

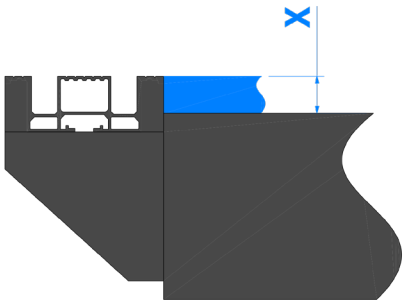

ACCESSORIES  
HANDRAILS



**KHL-9707**  
Straight pipe out of natural  
stainless steel

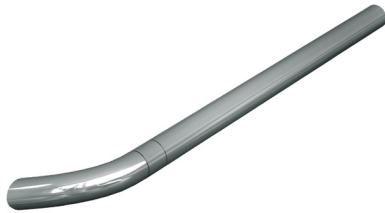

**KHL-9014**  
Curved pipe out of  
natural stainless steel

ACCESSORIES  
CEILING

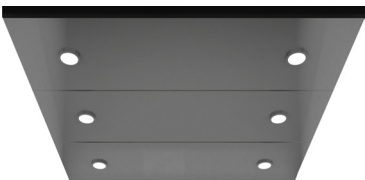

ZD-01



ZD-05



ZD-02

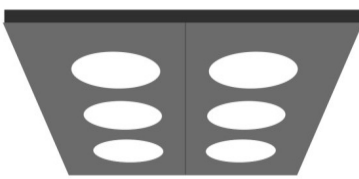

ZD-06



ZD-03



ZD-07



ZD-04

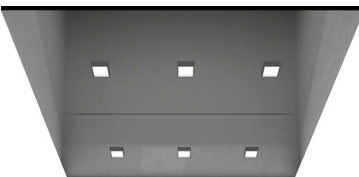

ZD-08



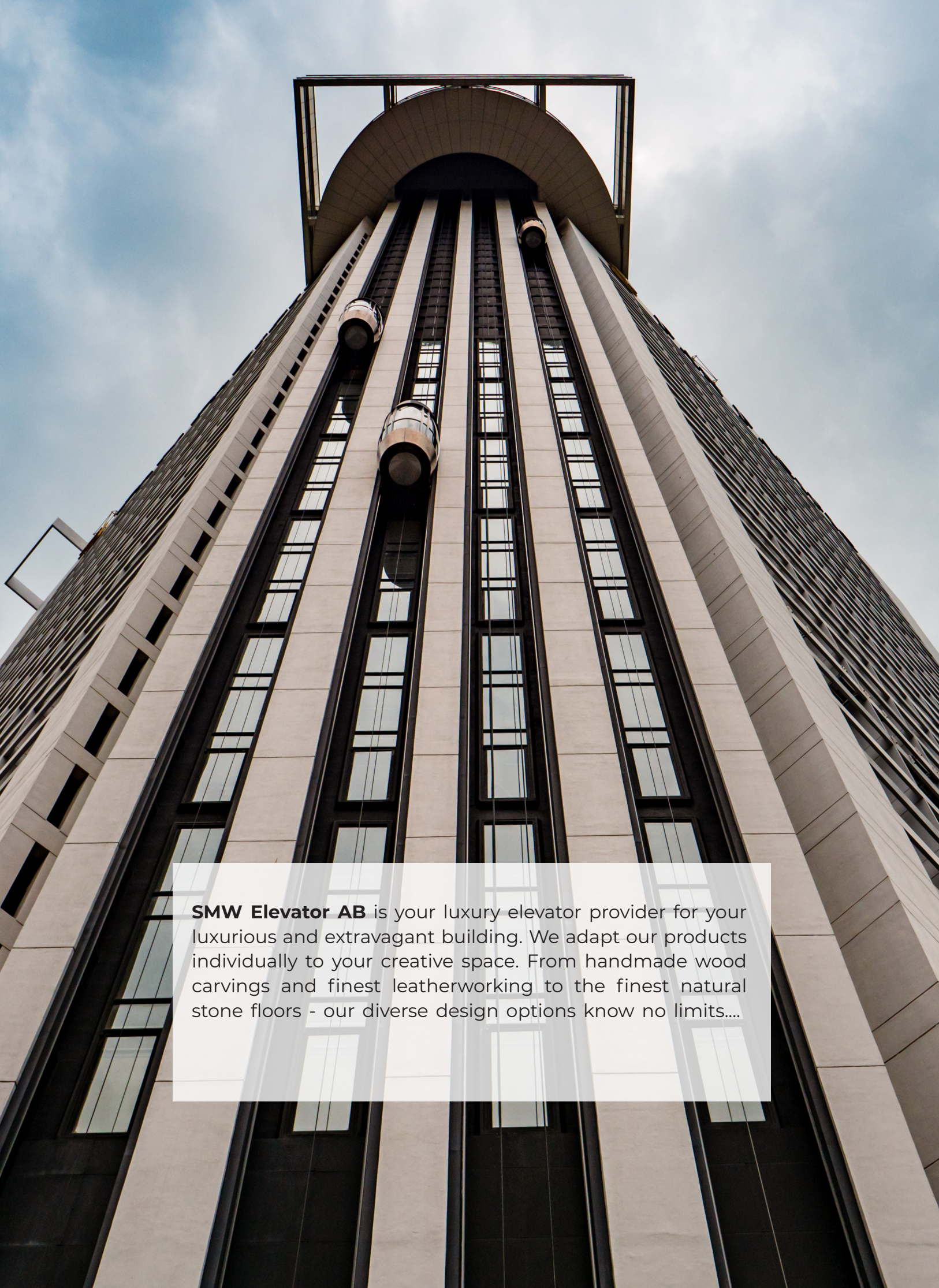

**SMW Elevator AB** is your luxury elevator provider for your luxurious and extravagant building. We adapt our products individually to your creative space. From handmade wood carvings and finest leatherworking to the finest natural stone floors - our diverse design options know no limits....









PERFORMANCE MATRIX MRL  
machineroomless

B-CORE MRL EN81-20/50																				
Rated load <b>Q</b> up to	kg	450			630				1000				1600				2000			
Suspension		2:1			2:1				2:1				2:1				2:1			
Rated speed <b>v<sub>N</sub></b>	m/s	1.0	1.6	1.75	1.0	1.6	1.75	2.0	1.0	1.6	1.75	2.0	1.0	1.6	1.75	2.0	1.0	1.6	1.75	
Travel height <b>TH</b> max.	m	40	60	60	40	60	60	80	40	60	60	80	40	80	80	80	40	80	80	
Open through <b>OT</b>	optional																			
SHAFT DIMENSIONS																				
Shaft width <b>SW</b> min.	mm	KB + 500			KB + 500				KB + 500				KB + 550				KB + 600			
Shaft width <b>SW</b> max.	mm	KB + 1100			KB + 1100				KB + 1100				KB + 1200				KB + 1300			
Shaft depth <b>SD</b> min.	mm	KT + TP + 80			KT + TP + 80				KT + TP + 80				KT + TP + 80				KT + TP + 80			
<b>SD</b> at <b>OT</b>	mm	KT + 2x TP			KT + 2x TP				KT + 2x TP				KT + 2x TP				KT + 2x TP			
Shaft pit <b>SP</b>	mm	1100	1200	1300	1100	1200	1300	1400	1100	1200	1300	1400	1100	1200	1300	1400	1200	1300	1400	
<b>SP</b> min.	mm	400	-		400	-		400	-		500	-		-			-			
Shaft head <b>SH</b> min.	mm	KH + 1200	KH + 1400	KH + 1500	KH + 1200	KH + 1400	KH + 1500	KH + 1850	KH + 1200	KH + 1400	KH + 1500	KH + 1850	KH + 1300	KH + 1500	KH + 1600	KH + 1950	KH + 1400	KH + 1600	KH + 1750	
<b>SH</b> reduced min.	mm	KH + 500	-		KH + 500	-		KH + 500	-		-		-			-				
DOORS																				
Door width <b>DW</b>	mm	600 - 800			700 - 900				700 - 1200				900 - 1300				900 - 2000			
Door height <b>DH</b>	mm	2000 - 2500			2000 - 2500				2000 - 2500				2000 - 2500				2000 - 2500			
Door type	mm	2PS/4PC			2PS/2PC/4PC				2PS/2PC/4PC				2PS/2PC/4PC				2PS/2PC/4PC			
Door package <b>DP</b> (frame on landing)	mm	275/275			275/205/275				275/205/275				275/205/275				275/205/275			
Door package <b>DP</b> (frame in shaft)		300/300			300/230/300				300/230/300				300/230/300				300/230/300			
CABIN DIMENSIONS																				
Cabin width <b>CW</b>	mm	900 - 1100			900 - 1500				1000 - 2100				1200 - 2100				1400 - 2100			
Cabin depth <b>CD</b>	mm	1100 - 1400			1100 - 1800				1100 - 2200				1400 - 2500				1600 - 2700			
Cabin height <b>CH</b> rough	mm	2100 - 2700			2100 - 2700				2100 - 2700				2100 - 2700				2100 - 2700			
Standard dimensions <b>CW x CD x CH</b>	mm	1000 x 1250 x 2200			1100 x 1400 x 2200				1100 x 2100 x 2200 1600 x 1400 x 2200				1400 x 2400 x 2200 1600 x 2100 x 2200				1500 x 2700 x 2300 1750 x 2300 x 2200			

*This table intends to give an orientation. A lot of different executions are possible on demand.*

PERFORMANCE MATRIX MR  
machine room above

B-CORE MR EN81-20/50																					
Rated load <b>Q</b> up to	kg	630					1000					1600					2000				
Suspension		2:1					2:1					2:1					2:1				
Rated speed <b>v<sub>N</sub></b>	m/s	1.0	1.6	1.75	2.0	2.5	1.0	1.6	1.75	2.0	2.5	1.0	1.6	1.75	2.0	2.5	1.0	1.6	1.75		
Travel height <b>TH</b> max.	m	40	60	60	80	100	40	60	60	80	100	40	80	80	80	100	40	80	80		
<b>Open through OT</b>																					
SHAFT DIMENSIONS																					
Shaft width <b>SW</b> min.	mm	KB + 500					KB + 500					KB + 550					KB + 600				
Shaft width <b>SW</b> max.	mm	KB + 1100					KB + 1100					KB + 1200					KB + 1300				
Shaft depth <b>SD</b> min.	mm	KT + TP + 80					KT + TP + 80					KT + TP + 80					KT + TP + 80				
<b>SD</b> at <b>OT</b>	mm	KT + 2x TP					KT + 2x TP					KT + 2x TP					KT + 2x TP				
Shaft pit <b>SP</b>	mm	1100	1200	1300	1400	1750	1100	1200	1300	1400	1750	1100	1200	1300	1400	1750	1200	1300	1400		
<b>SP</b> min.	mm	400	-				400	-				500	-				-				
Shaft head <b>SH</b> min.	mm	KH + 1200	KH + 1400	KH + 1500	KH + 1650	KH + 1900	KH + 1200	KH + 1400	KH + 1650	KH + 1900	KH + 2100	KH + 1200	KH + 1400	KH + 1500	KH + 1650	KH + 1900	KH + 1200	KH + 1400	KH + 1500		
<b>SH reduced min.</b>	mm	KH + 500	-				KH + 500	-				-				-					
Height machine room <b>MRH</b> min.	mm	2000																			
DOORS																					
Door width <b>DW</b>	mm	700 - 900					700 - 1200					900 - 1300					900 - 2000				
Door height <b>DH</b>	mm	2000 - 2500					2000 - 2500					2000 - 2500					2000 - 2500				
Door type	mm	2PS/2PC/4PC					2PS/2PC/4PC					2PS/2PC/4PC					2PS/2PC/4PC				
Door package <b>DP</b> (frame on landing)	mm	275/205/275					275/205/275					275/205/275					275/205/275				
Door package <b>DP</b> (frame in shaft)		300/230/300					300/230/300					300/230/300					300/230/300				
CABIN DIMENSIONS																					
Cabin width <b>CW</b>	mm	900 - 1500					1000 - 2100					1200 - 2100					1400 - 2100				
Cabin depth <b>CD</b>	mm	1100 - 1800					1100 - 2200					1400 - 2500					1600 - 2700				
Cabin height <b>CH</b> rough	mm	2100 - 2700					2100 - 2700					2100 - 2700					2100 - 2700				
Standard dimensions <b>CW x CD x CH</b>	mm	1100 x 1400 x 2200					1100 x 2100 x 2200 1600 x 1400 x 2200					1400 x 2400 x 2200 1600 x 2100 x 2200					1500 x 2700 x 2300 1750 x 2300 x 2200				

*This table intends to give an orientation. A lot of different executions are possible on demand.*



CROSS SECTIONS

VERTICAL SECTIONS MRL

2PS – 2 panel side opening  
single entrance – 1 entrance

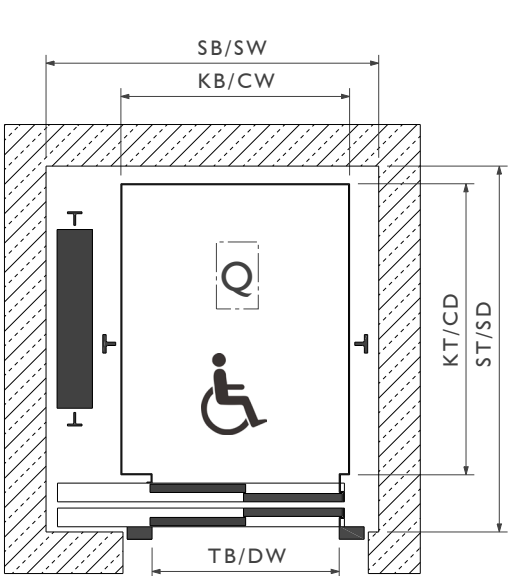

2PS – 2 panel side opening  
open through – 2 entrances

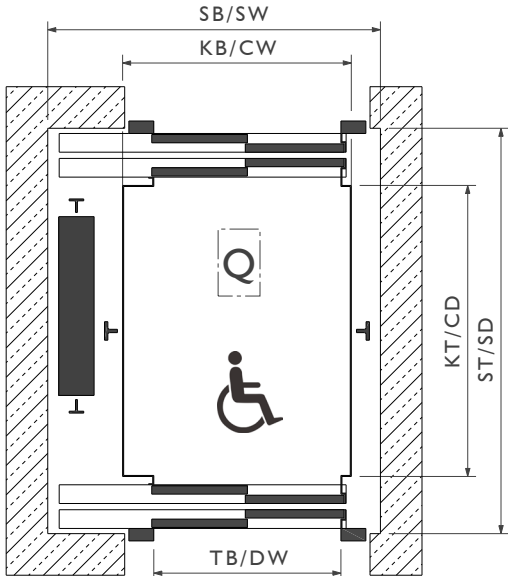

2PC – 2 panel central opening  
single entrance – 1 entrance

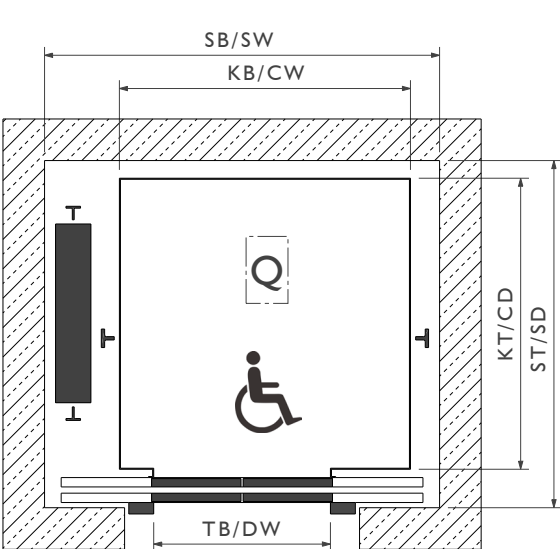

2PC – 2 panel central opening  
open through – 2 entrances

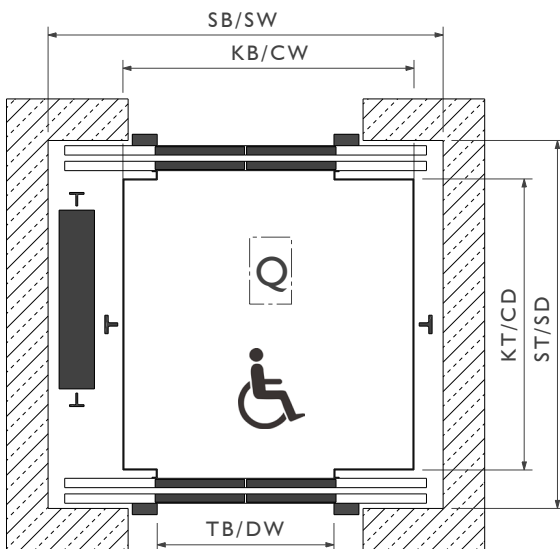

STANDARD SHAFT HEAD  
STANDARD SHAFT PIT

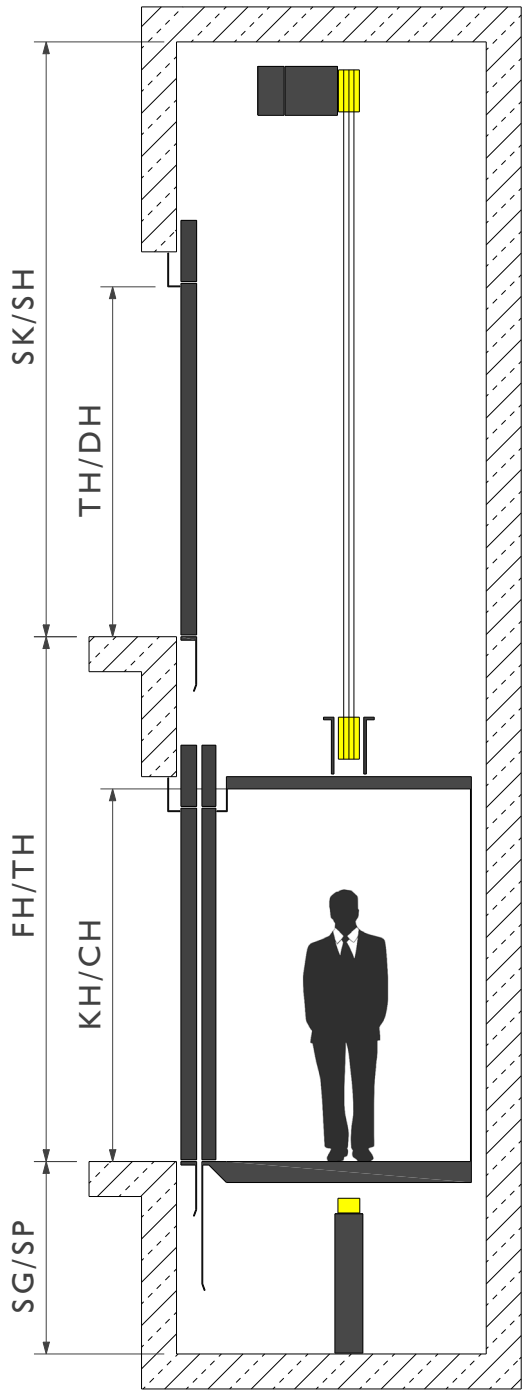

REDUCED SHAFT HEAD  
REDUCED SHAFT PIT

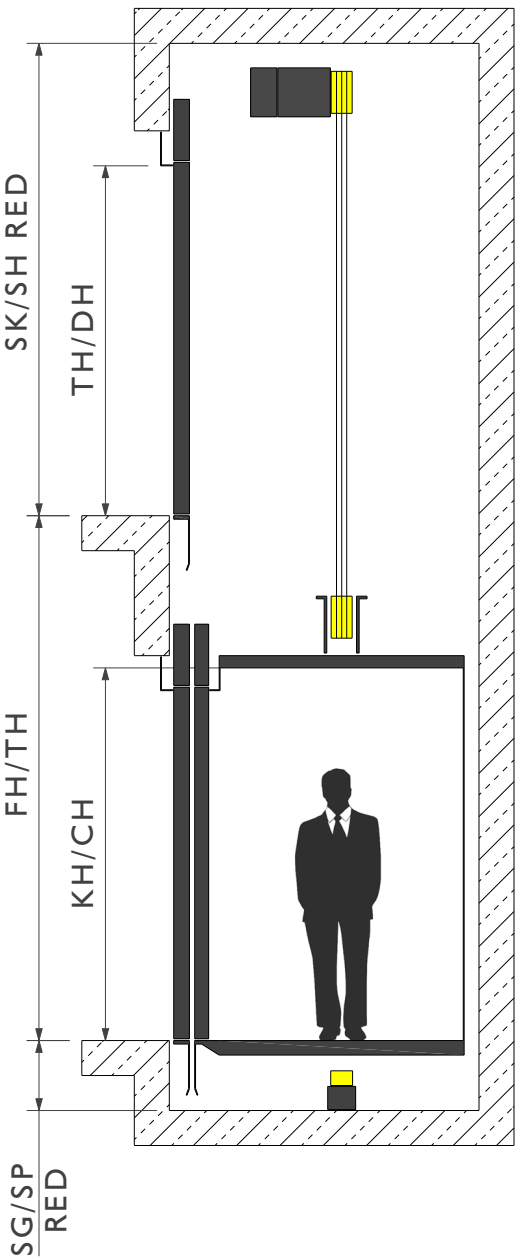



VERTICAL SECTIONS MR

STANDARD SHAFT HEAD  
STANDARD SHAFT PIT

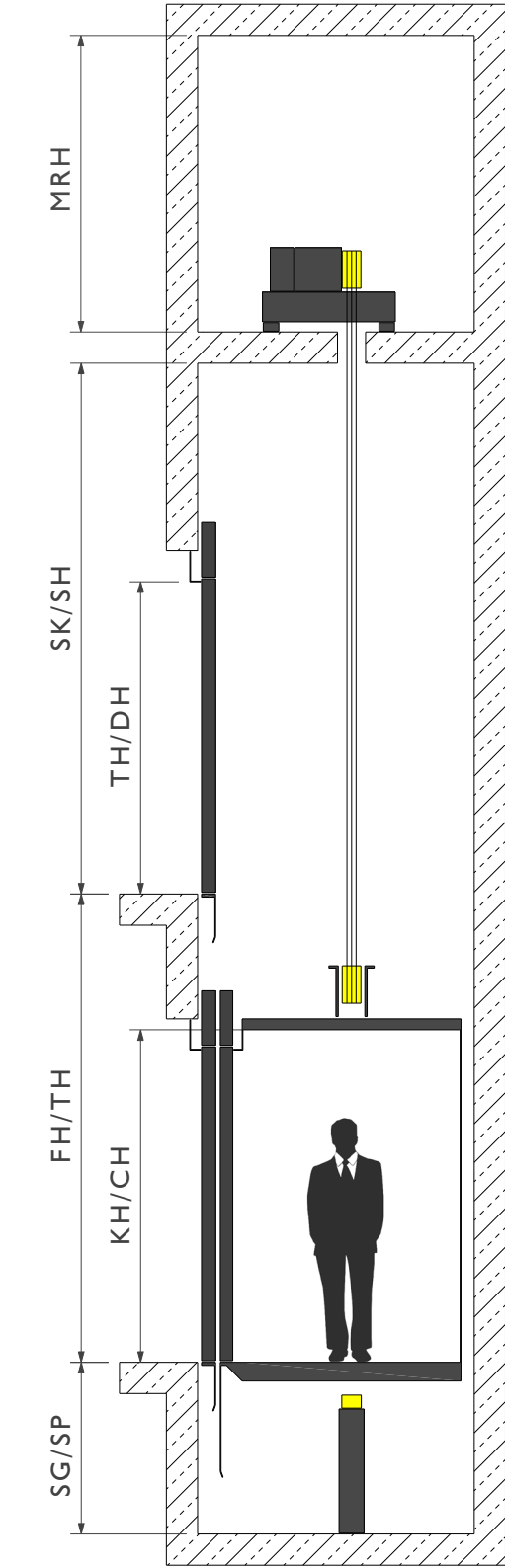

REDUCED SHAFT HEAD  
REDUCED SHAFT PIT

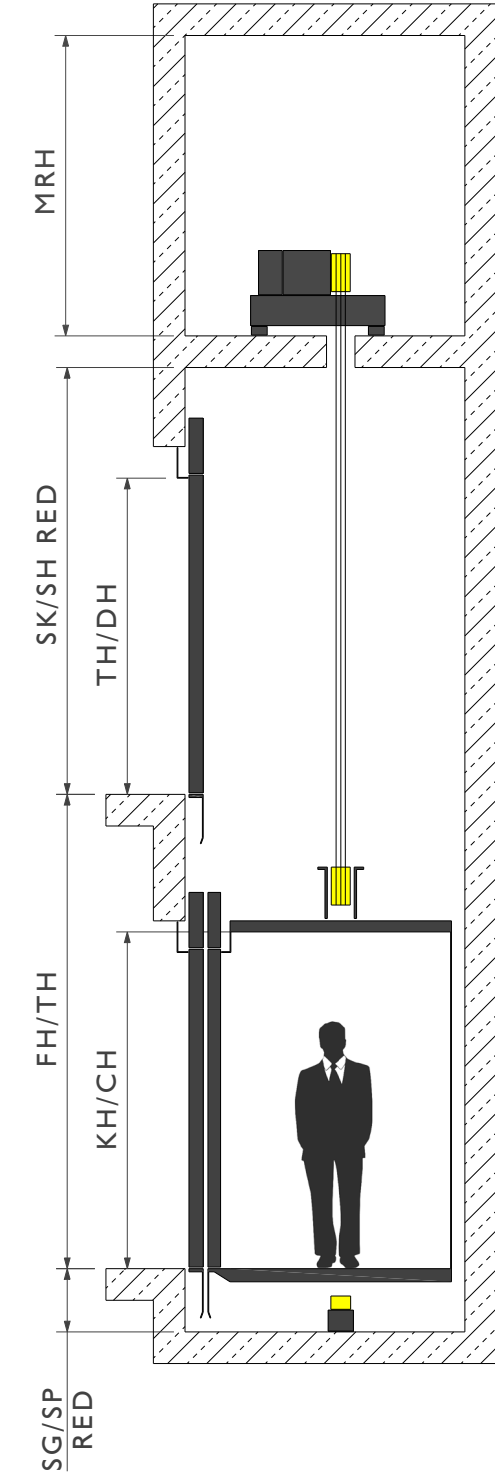

CONTROL CABINET MRL

COMPACT IN FRONT OF THE DOOR FRAME

- separate slim control cabinet in front of the door frame
- compact arrangement
- doors with fire protection applicable
- for central and side opening doors

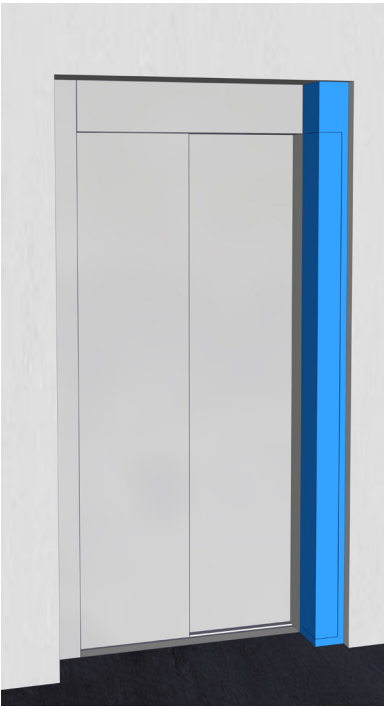
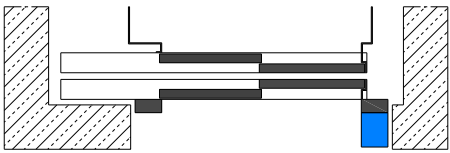

COMPACT INSIDE THE DOOR FRAME

- control cabinet integrated into the door frame
- most compact arrangement
- doors with fire protection not applicable
- side opening doors only

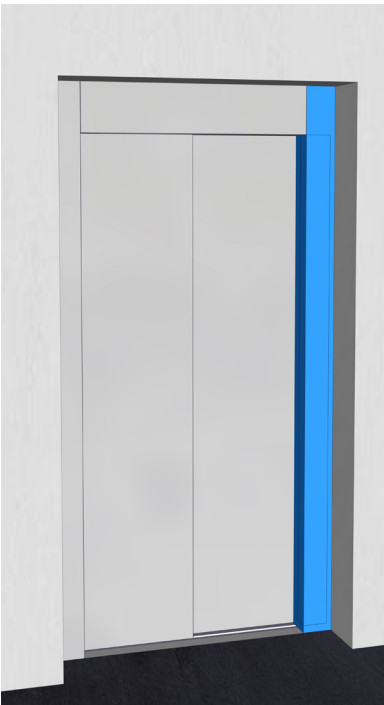
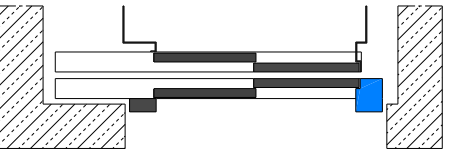



LAYOUT

CONTROL CABINET MRL

SEPARATE CONTROL CABINET

- separate flexibly positionable control cabinet
- most maintenance friendly
- doors with fire protection applicable
- independent to door execution

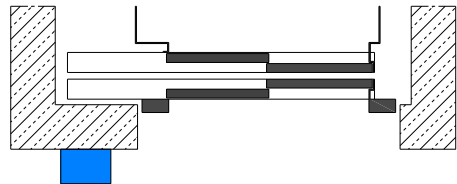





SMW Elevator AB  
Svarvarvägen 18  
142 50 Skogas/Stockholm  
Sweden

Email: [contact@smwelevator.se](mailto:contact@smwelevator.se)  
Website: [www.smwelevator.se](http://www.smwelevator.se)